

Stadt Verl

Straßenendausbau

Haferkamp

in Verl



● **Ing. Büro Hegers, Wilhelmshöhe 7, 33102 Paderborn**

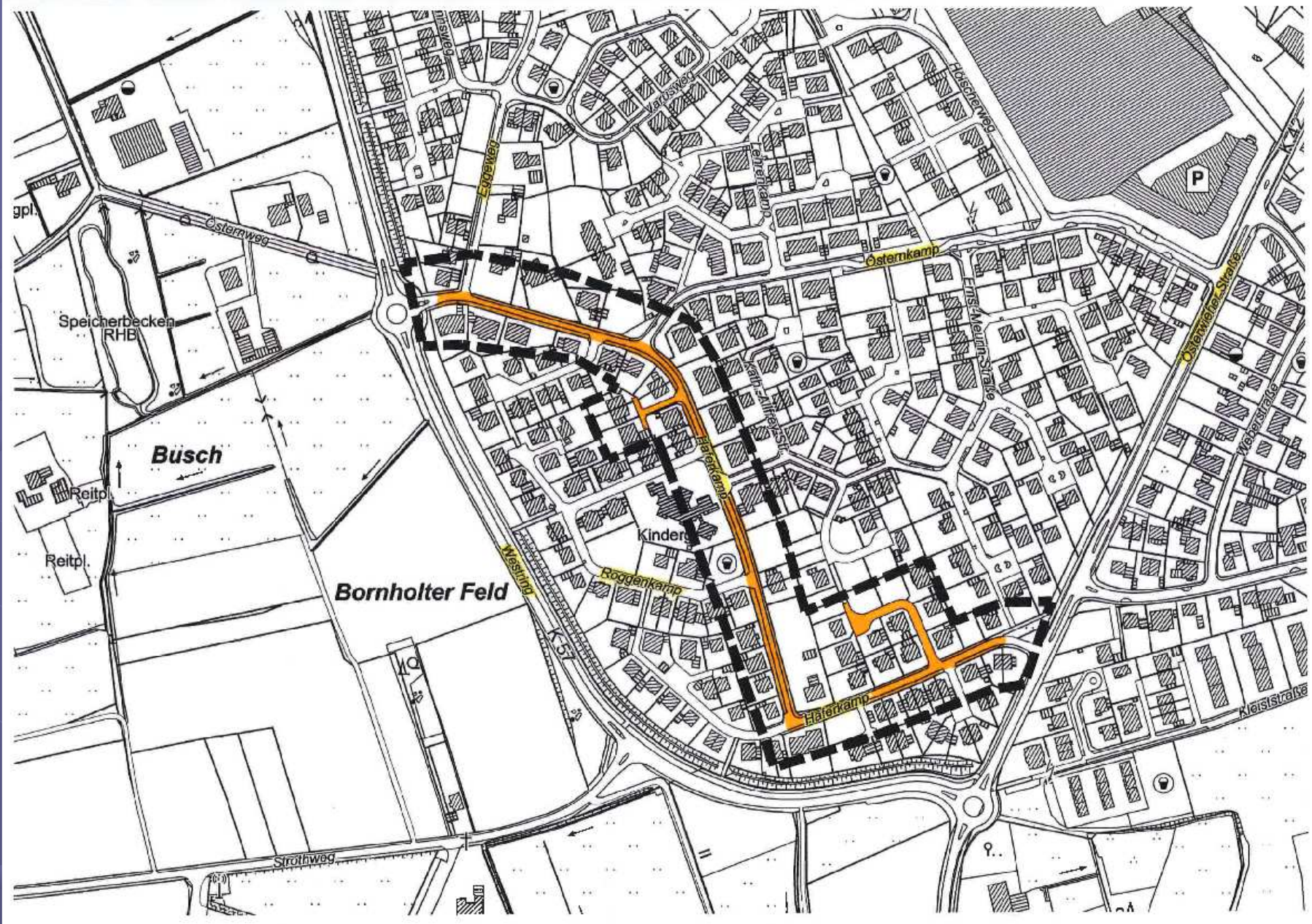



F1



F2



F3



F4



F5





F7



F8



F9



F10



F11



F12



F13



F14



F15



F16



F17



F18



F19



F20



F21



F22



F23



F24



F25



Variante 1

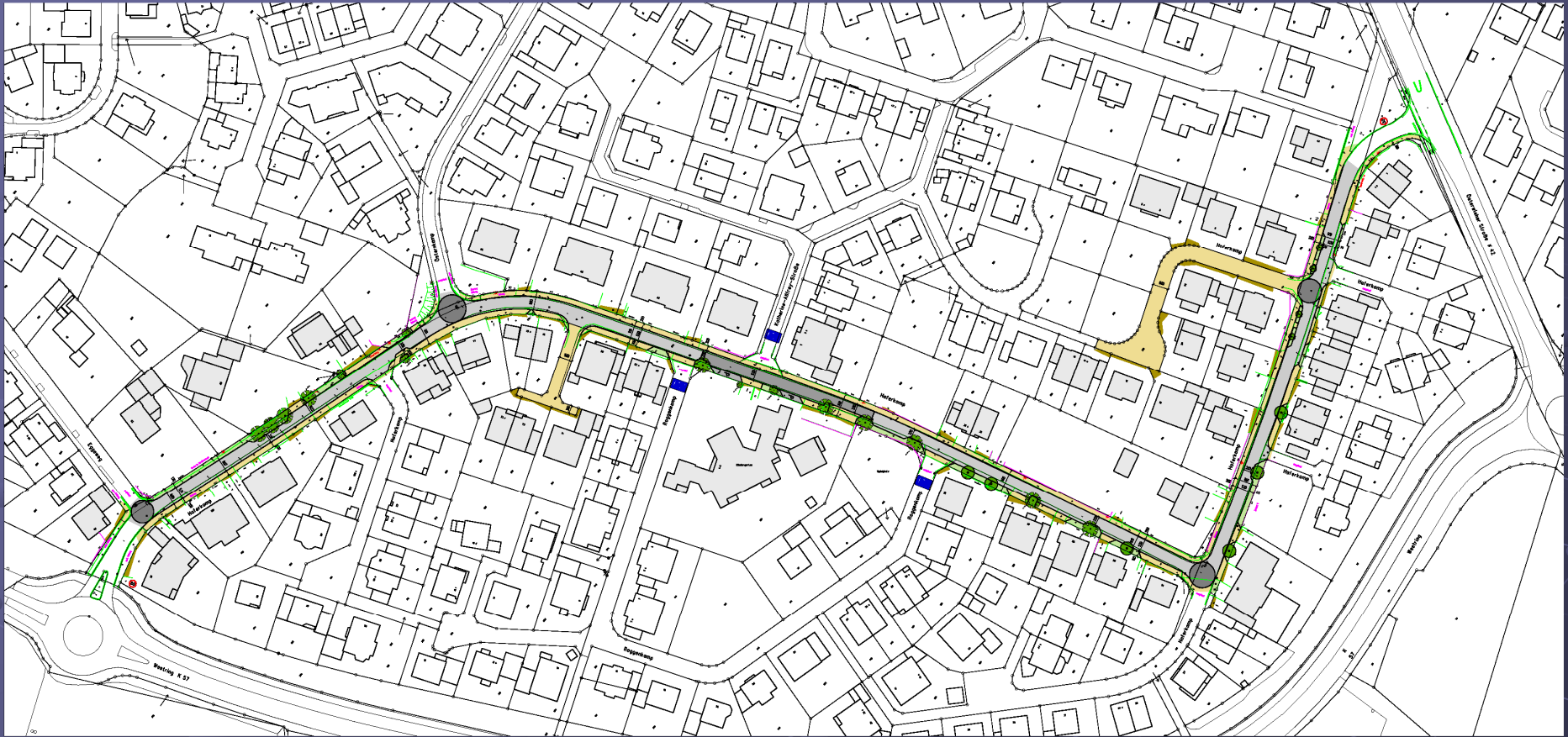

L 1 Variante 1

Regelquerschnitt - Variante 1

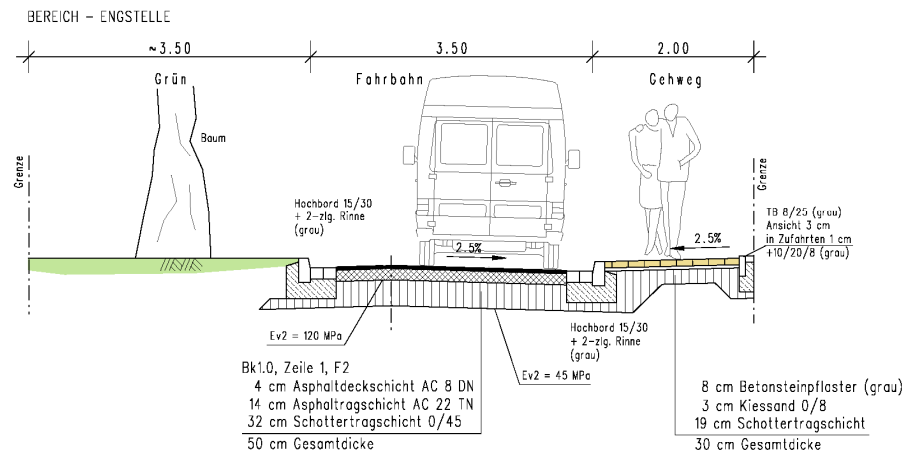
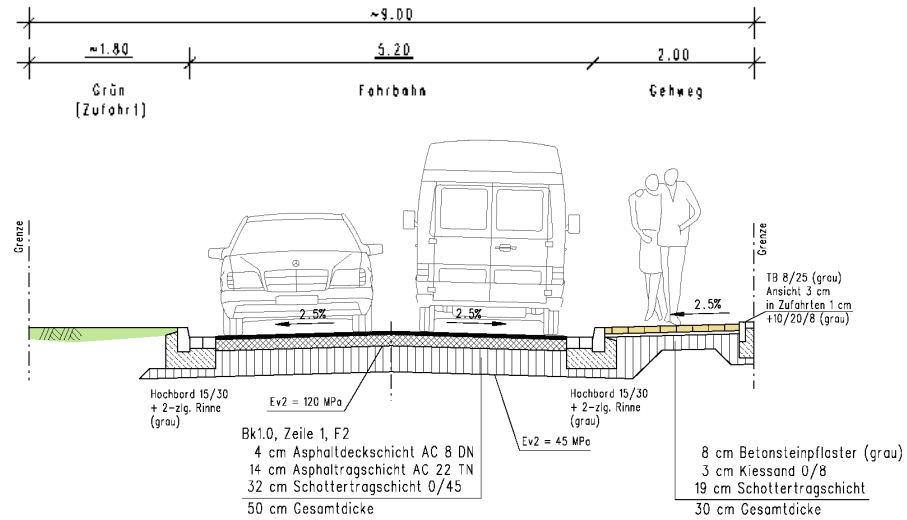

Regelquerschnitt - Stichwege

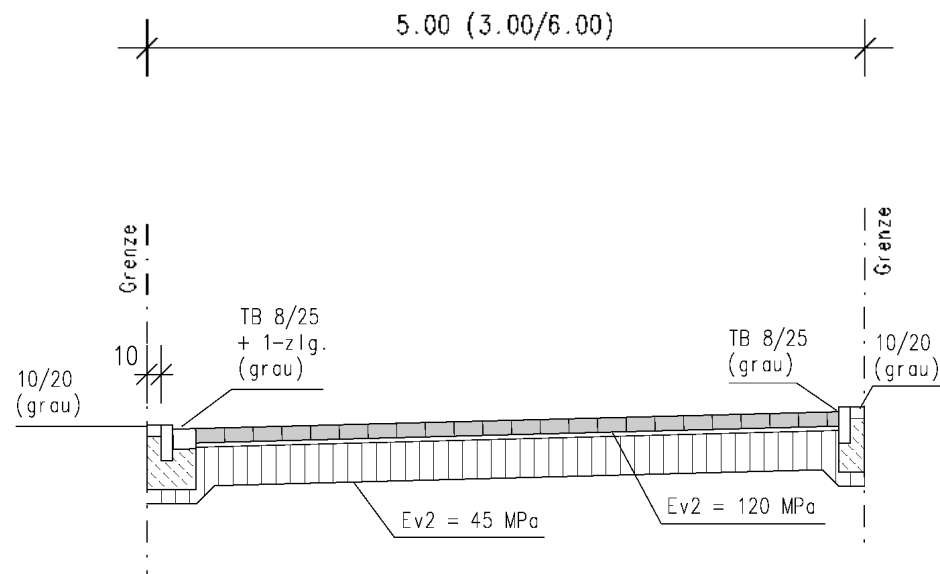

- 8 cm Betonsteinpflaster (grau)
- 3 cm Kiessand 0/8
- 29 cm Schottertragschicht 0/45
- 40 cm frostsicherer Oberbau



L1-1

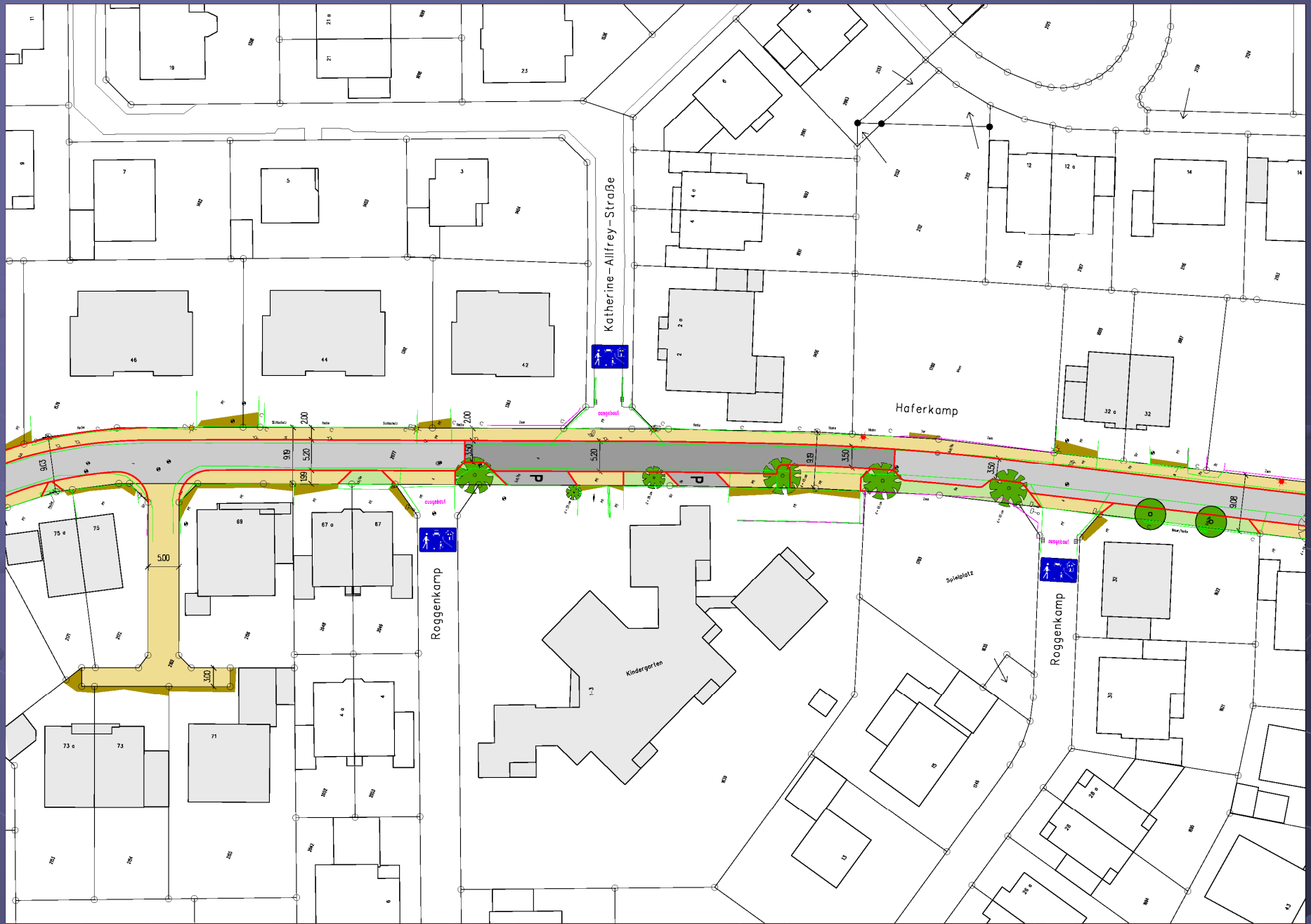



F1-1



F1-2



F1-3



F1-4



Variante 2

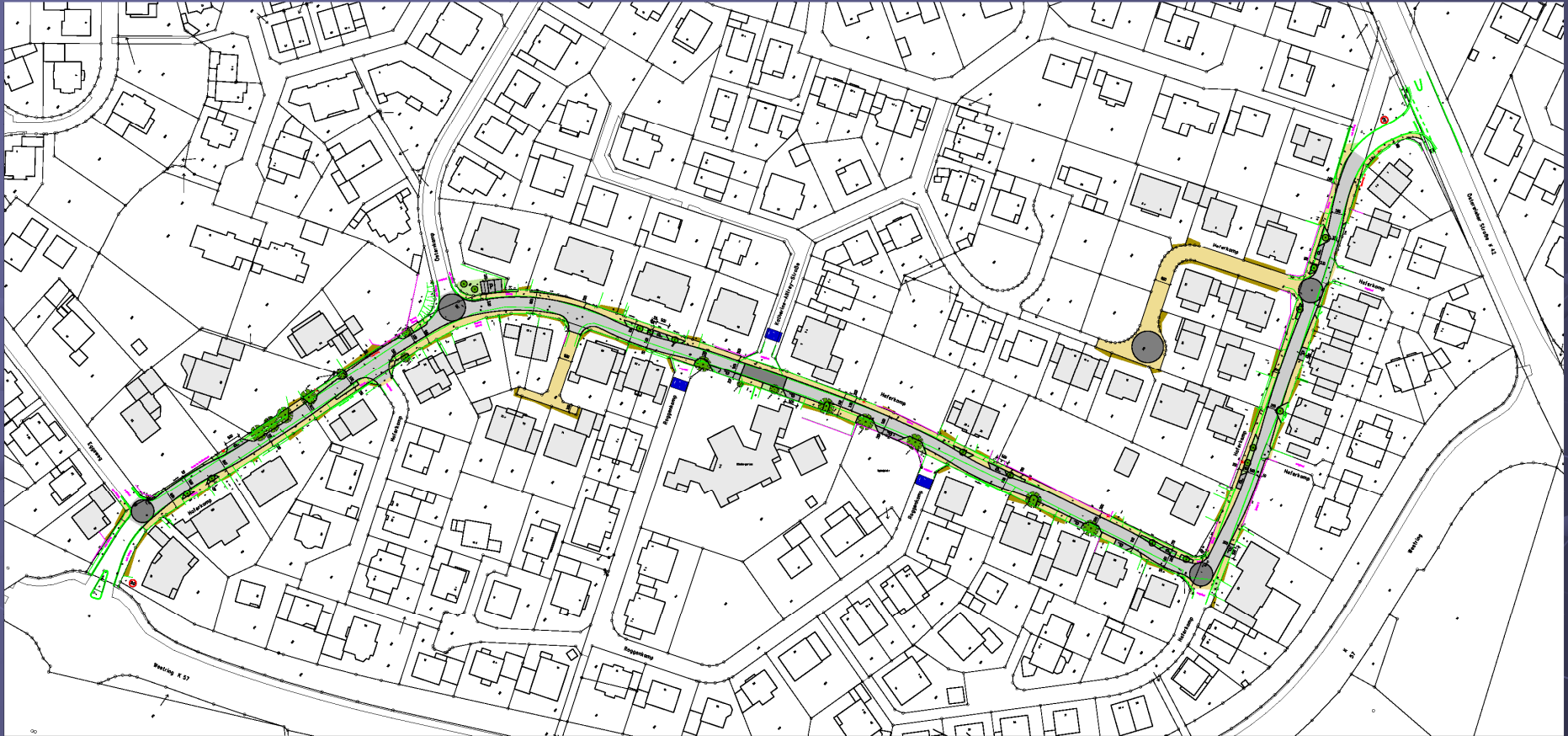

L 2 Variante 2

Regelquerschnitt - Variante 2

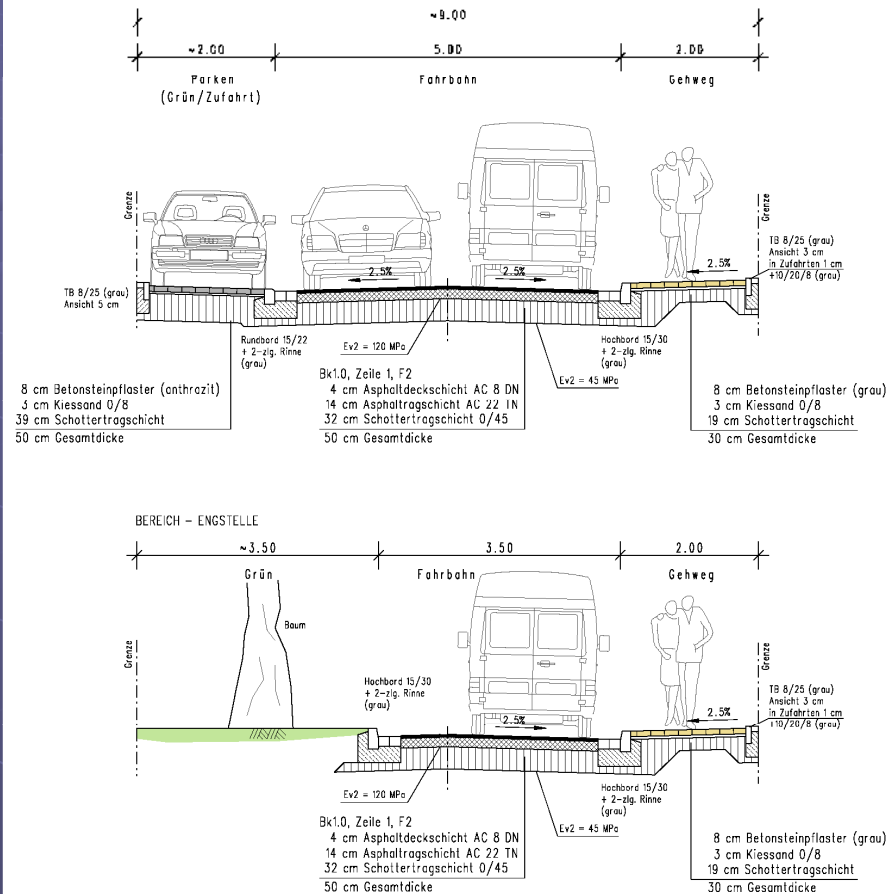

Regelquerschnitt - Stichwege

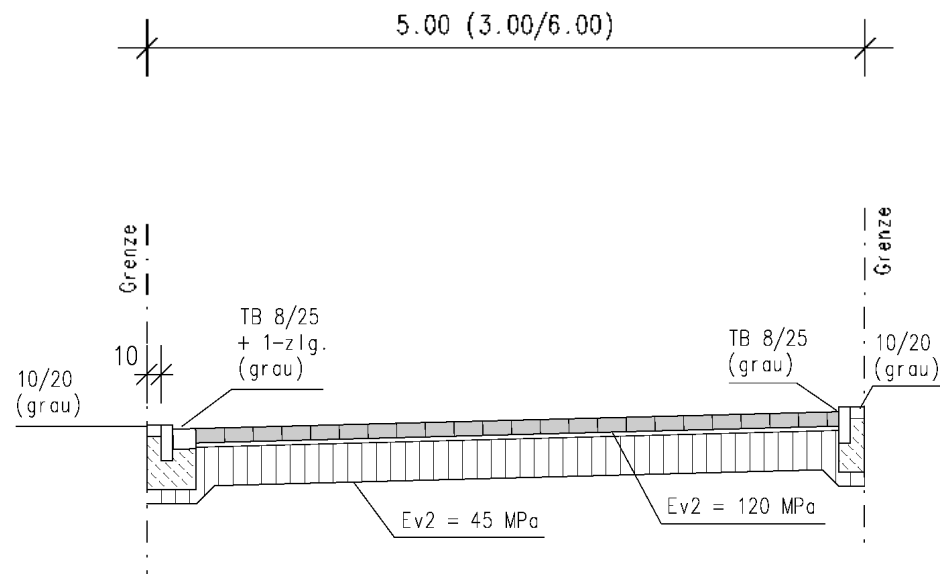

8 cm Betonsteinpflaster (grau)
3 cm Kiessand 0/8
29 cm Schottertragschicht 0/45
40 cm frostsicherer Oberbau



L2-1

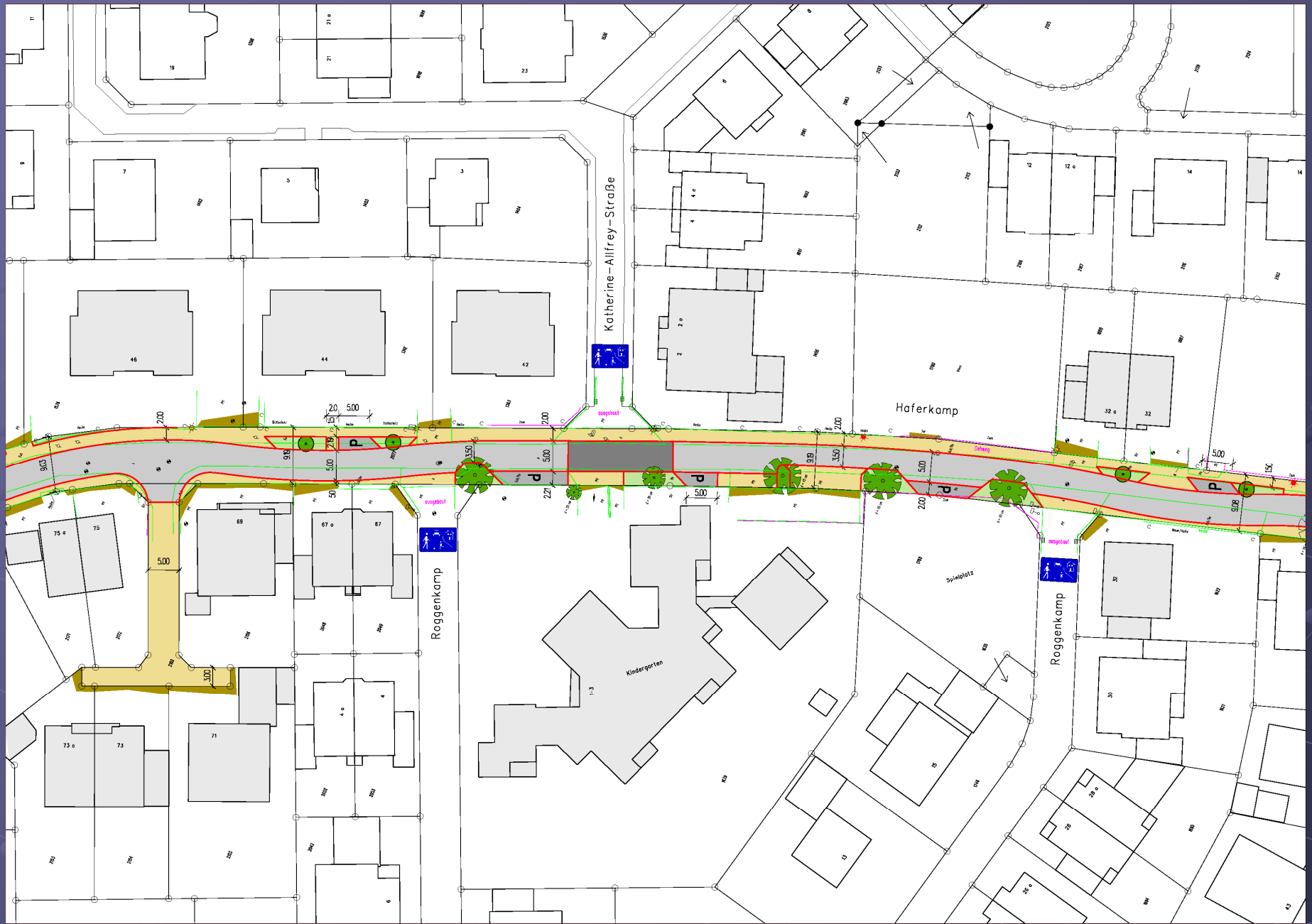



L 2-3



F2-1



F2-2



Vielen Dank
für Ihre
Aufmerksamkeit!